

The PlymoVent Firehouse systems cover your every need

■ No matter how your fire station is built and equipped, the versatility of the three PlymoVent Firehouse systems will always give you the best solution.

## Fire Station Neuenstein, Germany

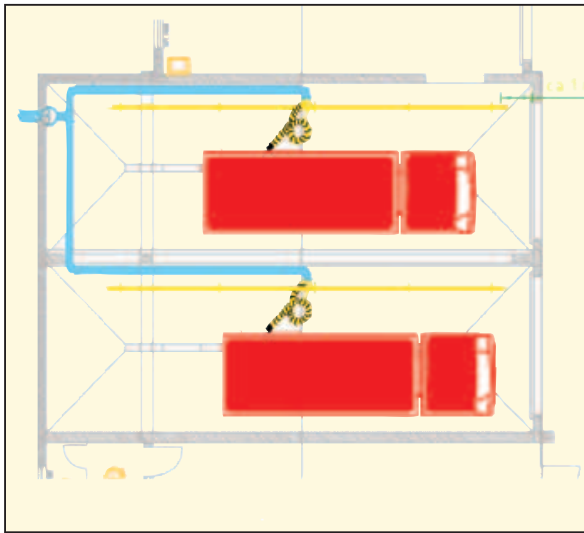

Products	Description
2 SBT-6-100-5	Sliding Balancer Track
1 FA-4700	Fan

## Fire Station Florsheim, Germany

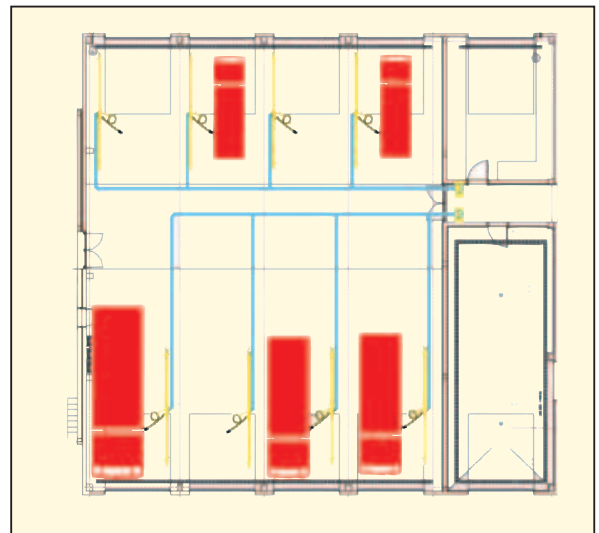

Products	Description
8 SBT-6-100-5	Sliding Balancer Track
2 FA-4700	Fan

## Tin Shui Wai Fire Station, Hong Kong

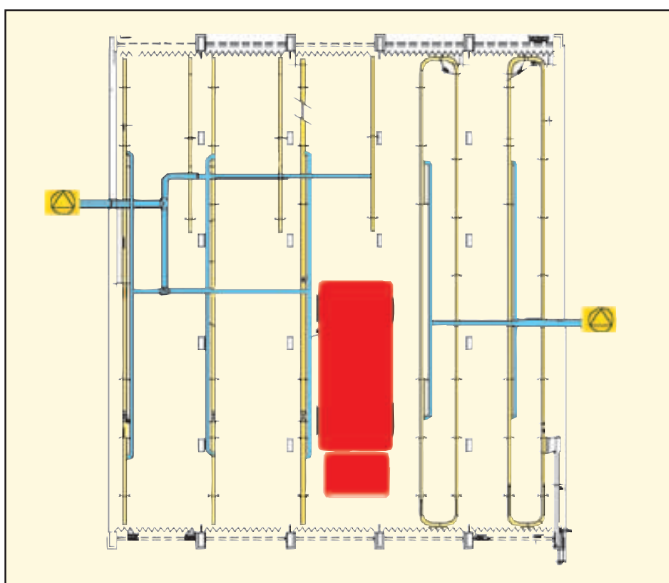

Products	Description
3 STR-9	Straight Rail
3 STR-24	Straight Rail
6 ICCA-100	Internal Crab
6 HPA-100-6-160	Hose Kit
2 RR	Looped Rail
6 MEC	Motordriven External Crab
6 HPA-100-6-120	Hose Package
1 FA-7500	Fan
1 FA-11000	Fan
2 PCU-1000	Control Unit
18 PC-500	Pressure Sensor

## Fire Station Perth Amboy, NJ, USA

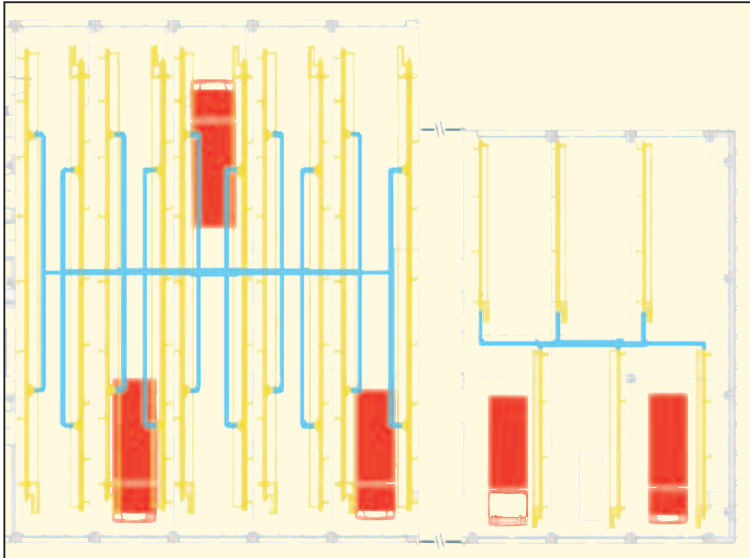

### Products

Products	Description
18 STR-24	Straight Rail
6 STR-9	Straight Rail
24 IC-100	Internal Crab
24 HPA-100-6-160	Hose Kit
1 TEV-798-50	Fan
1 TEV-764-50	Fan
2 TEVKIT-7	Fan outlet transition kit
24 ASE-12	Damper
1 FO-040	DCV Controller
1 FO-055	DCV Controller

## Fire Station Avesta, Sweden

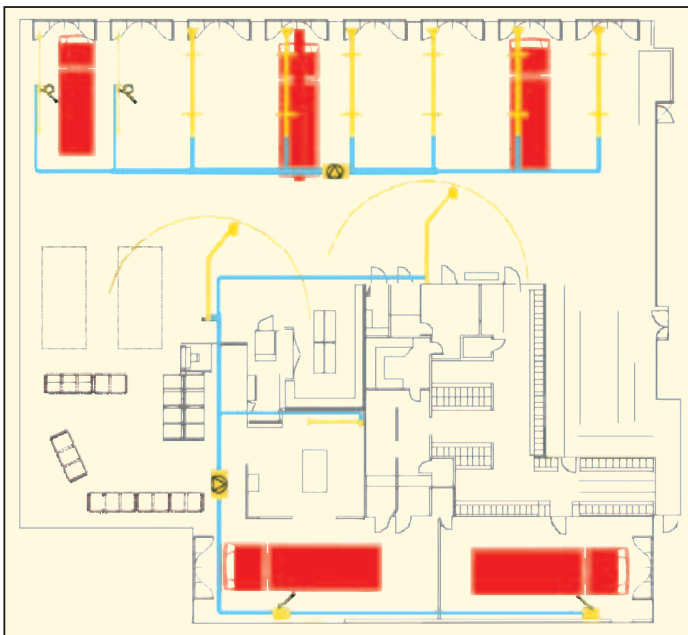

### Products

Products	Description
5 VSR-6	Vertical Stack Rail
2 SBT-6-100-5	Sliding Balancer Track
1 FA-7500	Fan
1 FS-4700	Fan
2 FEB-6-125	Swing-arm Hose Dropper
2 SER-850-125	Spring Exhaust Reel
1 MSA-160-3	MultiSmart®Arm